

# Assembly Instructions for Porch Systems

VixenHill.com  
800-423-2766

**General Carpentry** skills are required for Porch System installation. Also, check to see if your locality requires a building permit before ordering. When the porch is delivered, compare received components to those shown in your drawing. During installation, always "measure twice & cut once" as some variations will occur between the drawing and actual installed measurements. After trimming we recommend coating end grain and surfaces in contact with the floor with two coats of urethane.

## Tools Needed:

- Tape Measure
- Chalk Line
- Table Saw
- Stainless Steel
- Level
- Drill w/ drivers
- Router w/ 1/2" bit
- Screws & Nails
- Square
- Circular Saw
- Hammer
- Urethane & Brush
- Pencil
- Miter Saw
- Caulk
- Stepladder

**Panel Trimming** requires trimming equal amounts off each side of the panels plus up to 1/8" for panel expansion. Panel trimming can not exceed 3" per side or 2" if the panel contains a door. Panel tops and bottoms can be trimmed up to 2" each. If the bottom is trimmed the panel bottom will need a new 1/2" groove routed to accommodate the splined threshold.

**Post Trimming** for height between the floor and the header-beam usually requires trimming equal amounts off each end for symmetry. For tenon posts allow a 2" tenon length.

**Panel Installation** includes determining the inside and outside face of the panel. Refer to the drawing and note the sloping coped edge goes to the outside.

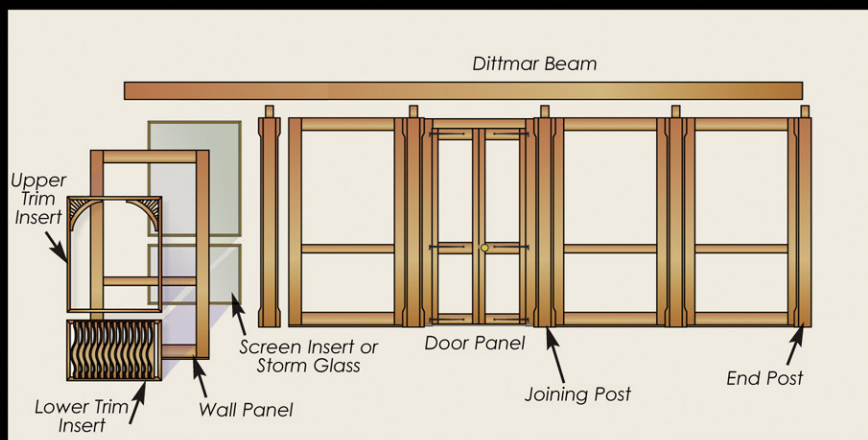

**Threshold** length is the distance between posts **after** the panel has been trimmed. Trim equal amounts off the threshold ends, caulk front & back edge then fasten to the floor through the spline with nails or screws.

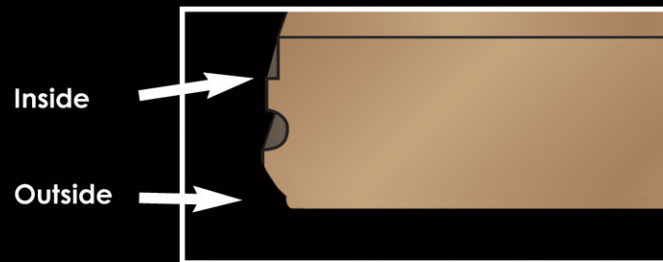
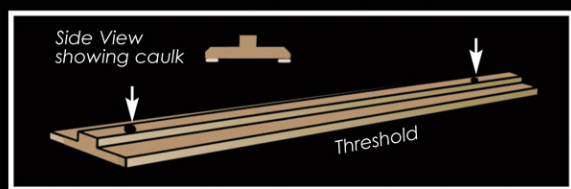

Joining Post-1

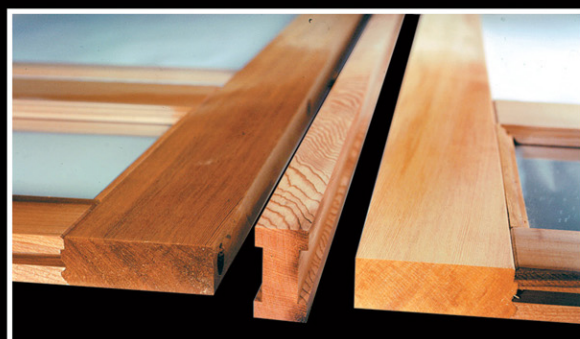

Joining Post-2



End Post - 2

## Posts Types

**End Posts** attach to the house or existing posts.

**Joining Posts** join wall panels or door panels together.

**Split Posts** (noted by the white stripe) are necessary when installing the last panel on a porch side. Simply rip the post where indicated by the stripe.

**Corner Posts** must be plumb and square at each corner.

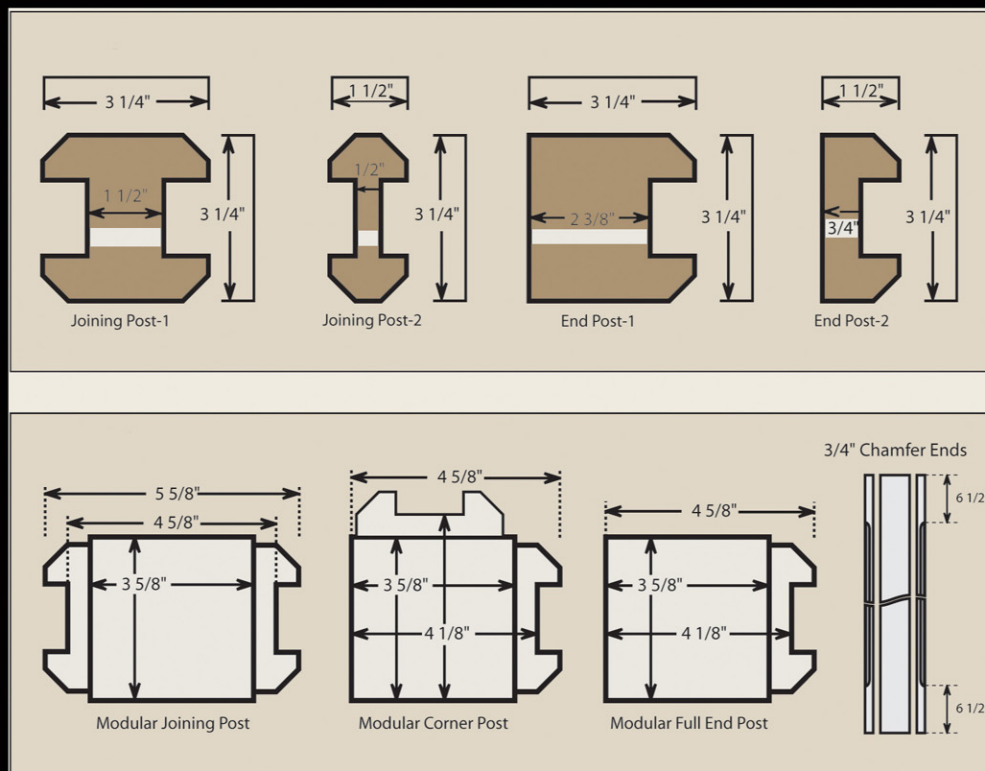

**Post Anchoring** depends on the decking material and accessibility of the underside of the deck.

**Masonry slabs** require 2" core holes at post-center locations and mortar mix to grout the post anchor straps into the holes.



**Wooden decking** offers several ways to anchor:

1) Core 2" holes at post locations to accommodate post straps and lag them to sub-deck cross braces;

2) Lag-bolt through a sub-deck cross brace into the post bottoms;

3) Toe-screw the posts to the wooden deck just prior to panel insertion.

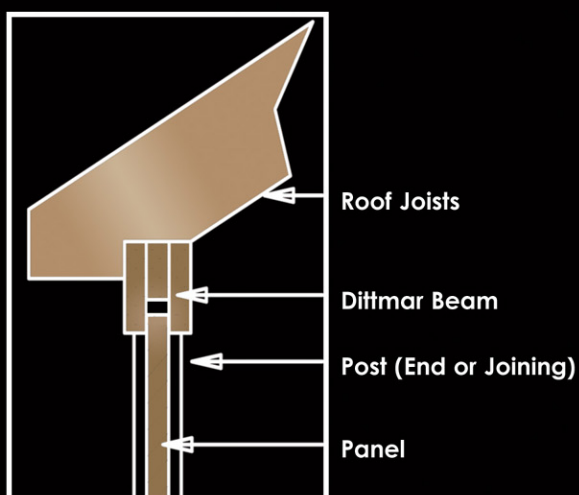

## Dittmar Header Beams

consist of three pieces of wood fastened together to form a header beam. The middle piece has a height dimension 2" less than those on either side and a thickness of 1 9/16". This provides a channel for post tenons and a pocket for the tops of the 1 1/2" wall panels. The depth of the channel allows the wall panel to be lifted upward then keyed downward onto the threshold.

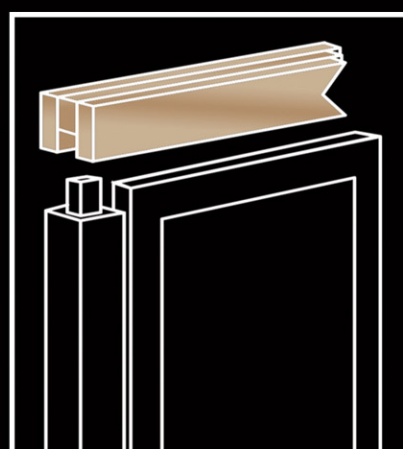

# Step-By-Step Instructions

VixenHill.com  
800-423-2766



**Begin** from the house and work towards the porch front; trim panels, posts and thresholds as you go. Generally the last panel will involve some size adjustment. Latex caulk should be used beneath the thresholds and in the post channels.

**Setup:** Confirm measurements of your deck with those on your layout drawing. Next sort porch panels and posts placing them in proximity of where they will be installed.

**1)** Size and align the house joining posts per drawing and attach it with screws. Use masonry mastic on the back side when installing on flat surfaces. Scribe post width then remove siding behind the post if the joining post installs against a wall with siding.

**2)** Trim the wall panels as you install them per the layout drawing by removing equal amounts from both edges and the required amount from the top to accommodate the header beam. Remember that the panel sits on a 3/4" threshold so when a Dittmar Header Beam with a channel is **not used**, the panel height should be the distance from the floor to header **minus 3/4"**. When using a Dittmar Header Beam, trim the panel to the distance from floor to header.

**Sloping Deck:** If the deck slopes start with the sloping sides. It is necessary to loosely pre-assemble the panels and posts on a flat surface and chalk-line the slope on the bottoms for trimming. Note that after trimming the panel bottoms, a new 1/2" groove must be routed to accommodate the splined threshold. Doors should be hinged to swing away from the slope **or** outward.



**Installing the last panel** on each porch side requires split posts (noted by the white stripe in drawing on front page). Simply rip the post in half, as seen below on a Joining Post.

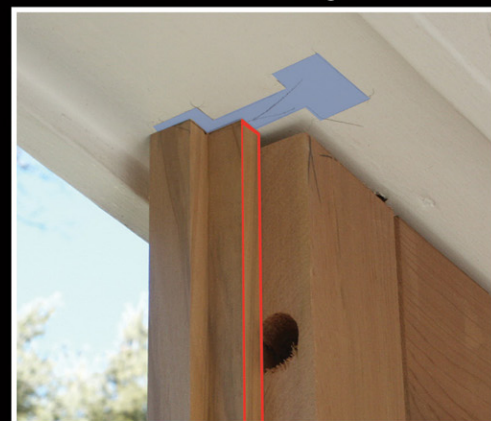

## Trim Inserts

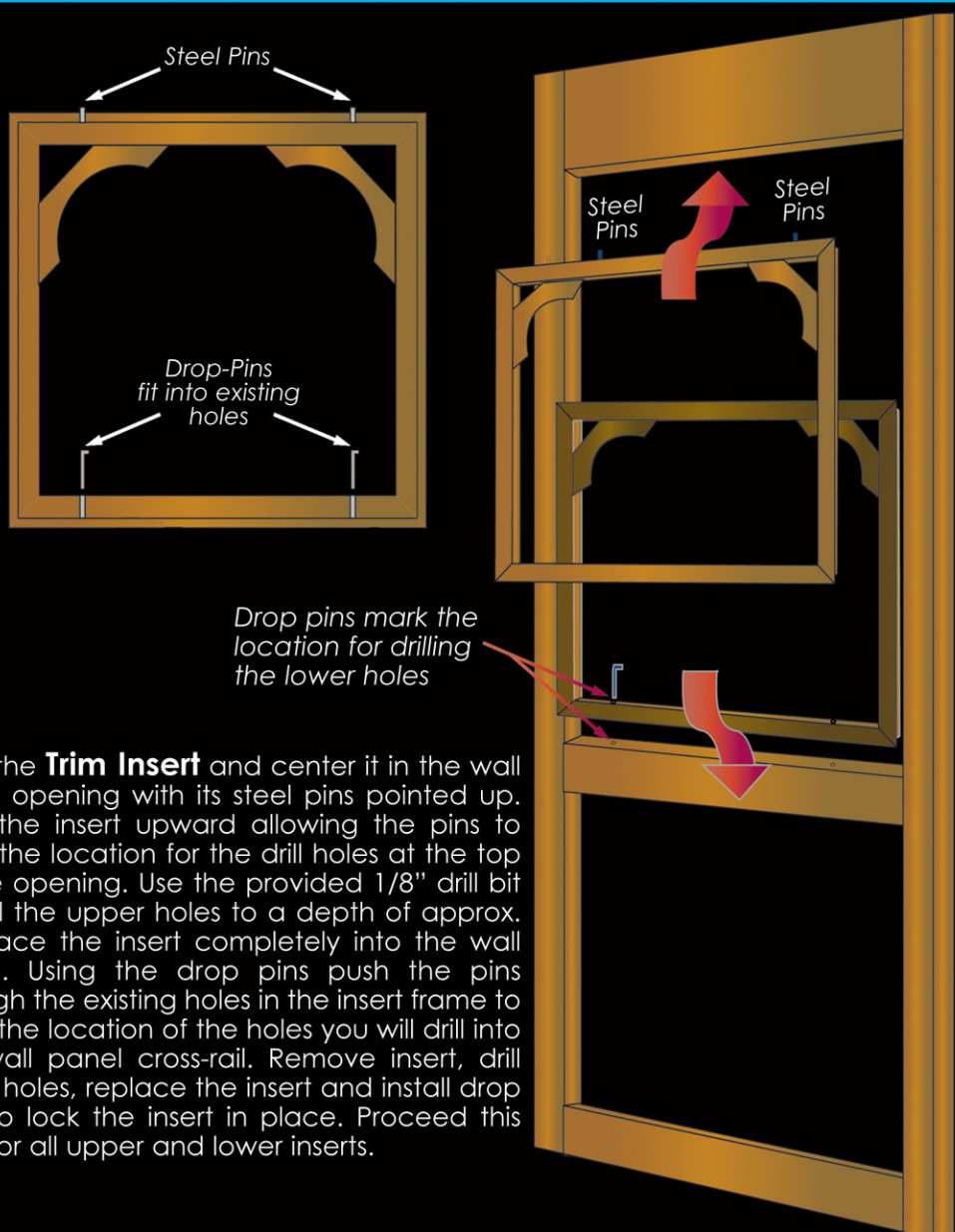

Take the **Trim Insert** and center it in the wall panel opening with its steel pins pointed up. Push the insert upward allowing the pins to mark the location for the drill holes at the top of the opening. Use the provided 1/8" drill bit to drill the upper holes to a depth of approx. 1". Place the insert completely into the wall panel. Using the drop pins push the pins through the existing holes in the insert frame to mark the location of the holes you will drill into the wall panel cross-rail. Remove insert, drill lower holes, replace the insert and install drop pins to lock the insert in place. Proceed this way for all upper and lower inserts.

**Doors** for most openings are available as double French door or a single door. Single 36" wide doors are usually pre-hung and hinged left or right (viewed from the outside) to swing in or out as requested. French doors use strap hinges and only swing outward. Because mounting surfaces are not always level the door may "rack" and need trimming or hinge adjustment. Cedar door inserts install the same as with wall panels.



Below: Single Door



Below: French Door

